

DIP SHIELDED POWER INDUCTORS

LGS1622 SERIES



FEATURES:

- Excellent solderability and heat resistance
- Magnetically shielded type inductor, possible to decrease reflection noise
- Available for high density mount due to compact size
- Accomplished low total harmonics distortion as compared

APPLICATIONS:

- Suitable as choke for digital amp
- Car audio
- LCD and PDP TV
- 5.1ch Home theater

ELECTRICAL CHARACTERISTICS:

| Part Number | L uH $\pm 25\%$ | DCR m Ω Max | Rated current A Max | Allowable current A Max |
|--------------|--------------------|-----------------------|------------------------|----------------------------|
| LGS1622-100Y | 10 | 10 | 12 | 11 |
| LGS1622-120Y | 12 | 12 | 11 | 10.5 |
| LGS1622-150Y | 15 | 15 | 10 | 10 |
| LGS1622-220Y | 22 | 18 | 7 | 9.5 |
| LGS1622-330Y | 33 | 20 | 6 | 9 |
| LGS1622-470Y | 47 | 30 | 5 | 8 |

Note: 1. K= $\pm 10\%$, M= $\pm 20\%$, N= $\pm 30\%$

PHYSICAL CHARACTERISTICS:

WINDING:

Dimension: mm

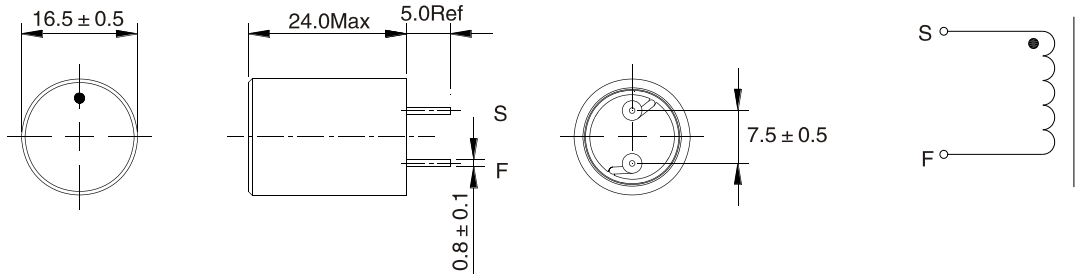

TECHNICAL INFORMATION:

- Testing: (Equivalent acceptable) Inductance: HP4342A, HP4284A
RDC: QuadTech 1880 Milliohm meter
Q- HP4342A - SRF-HP4191A
 - Operating temperature: -40°C to $+105^{\circ}\text{C}$
 - Storage Temperature: -40°C to $+105^{\circ}\text{C}$
 - Solder methods: Vapor Phase, Infrared Reflow
 - Resistance to soldering heat: 260°C for 10 seconds
 - Solvent resistance: Conforms to MIL-STD-202E
 - Marking: Inductance & Tolerance
- Note: All specifications subject to change without notice.